

# MARCATO 2.0



THE SLIDING DOOR WARDROBE SYSTEM.  
FOLLOW YOUR INSTINCTS. NOT THE CROWD.

**nolte**<sup>®</sup>  
MÖBEL

## WHY LIE BACK WHEN YOU CAN SPREAD OUT AND FLOAT?



Has your bedroom always been a place to lie back and dream? Then it's time you treated yourself to an upgrade: "Float and dream" is the motto of MARCATO 2.0 – the sliding door wardrobe system which allows you to follow your instincts, not the crowd. "Open the doors!" – to inspiring ideas...

Sliding door panorama wardrobe with 2 drawers // version 1 // 4 doors // width 320 cm and height 240 cm // body: silk grey // front: glass silk grey // handle fittings: chrome // bed frame: CONCEPT ME 500





Don't search, find – with intelligently organised drawers. The synchro-rod ensures that the opening mechanisms for both guides are always released at the same time. The result: perfectly aligned drawers and even smoother performance which can be triggered by pressing virtually anywhere on the front. Smile – everything responds to your lightest touch.

Scan and watch  
the film!



## 2 METRES OF PURE PERSPECTIVE: WHAT A PANORAMA!



Now it's really easy to choose your style for the day – thanks to clear and intelligent interior fittings. No searching, no stuffing, no bending. Just metres of space for your favourite clothes in refined drawers behind panoramic sliding doors.



## BIG IDEAS IN SMALL SPACES: WE CALL IT SMART LIVING.



Functional sliding door wardrobe with integrated shelf at the side and interior mirror // version 2 // 2 doors // width 200 cm and height 223 cm // body: polar white // front: white glass // handle fittings/lattice bars: chrome

Marcato 2.0 upgrade for greater functionality: The integrated side shelf unit can be fitted with a wide range of accessories such as additional shelves, metal rods, storage trays and hanger holders – the choice is yours. The LED light band ensures your favourite pieces are always perfectly lit. And abracadabra: after its star turn, the mirror panel disappears discretely behind the sliding door.







Sliding door wardrobe // version 1 // 3 doors // width 300 cm and height 240 cm // body: imit. Riviera oak // front: glass silk grey/crystal mirror // handle fitments: chrome // SONYO bed // bedside chest: ALEGRO STYLE

## DESIGN CONFIGURATOR

**YOU'RE JUST A FEW  
CLICKS AWAY FROM YOUR  
DREAM WARDROBE**



Scan and  
configure your favourite wardrobe.

Plan your ideal design and select:

1. Wardrobe type and number of lattice bars > 2. Body colour
3. Front colour > 4. Handle and lattice bar colours
5. Passe partout > 6. Done

[www.nolte-moebel.de/konfigurator.html](http://www.nolte-moebel.de/konfigurator.html)



Chest: ALEGRO STYLE //  
Body: imit. Riviera oak //  
Front: glass silk grey // handle fitments: chrome



GOOD IDEAS FIT INTO YOUR HOME.  
NOT THE OTHER WAY ROUND.



Anyone can do height x width x depth! The supreme test comes with rooms which demand creativity. And this is where the strengths of Marcato 2.0 become clear. From sloping ceilings at the side or rear to corner solutions and wardrobes that combine hinged and sliding doors for easy access to every corner – the system adapts to your room. Not the other way round.

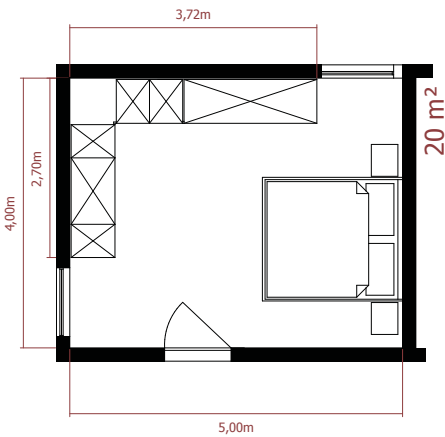

Corner combination consisting of: folding door unit, width 100 cm, sloping side, hinged door unit, width 50 cm, bookshelf, hinged door unit with drawers, width 100 cm, 90° corner unit, sliding door wardrobe with integrated shelf at the side, width 160 cm // height 240 cm // version 1 // body: imit. platinum oak // front: white glass // handle fitments: chrome // bed frame: CONCEPT ME 500 // bedside chest: CONCEPT ME 700

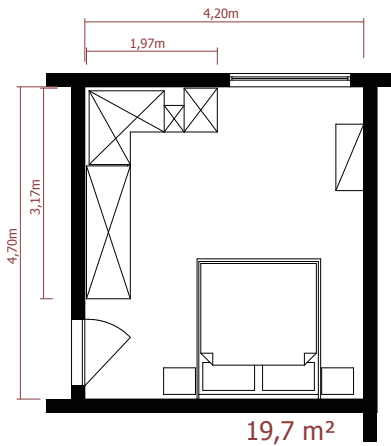

Corner combination consisting of: sliding door wardrobe with integrated shelf at the side, width 200 cm, 90° corner unit, bookshelf with drawers // hinged door unit, width 50 cm // height 240 cm // version 1 // body: polar white // front: polar white // handle fitments: chrome



The chrome surround for the drawers and door fronts is not just eye-catching – it also underlines the outstanding craftsmanship. Right: Problem solving par excellence. Easier to use, better access to spaces under sloping ceilings – large, double leaf folding doors open up the entire front.

## DOORS: FLOATING. COMBINATIONS: WEIGHTLESS.



*Version 4B*

Body and central belt: imit. Sonoma oak // front: crystal mirror/  
white glass // handle fittings and lattice bars: chrome



*Version 3*

Body: imit. Sonoma oak // front: imit. Sonoma oak/crystal mirror //  
handle fittings and lattice bars: frosted aluminium



*Version 2*

Body and passe partout: imit. Sonoma oak // front: white glass //  
handle fittings and lattice bars: chrome // passe partout incl. LED lighting



*Version 4B*

Body, central belt and passe partout: imit. Sonoma oak //  
front: white glass // handle fittings and lattice bars: chrome //  
passe partout incl. LED lighting



## SLIDE, PULL OR FOLD: OPEN SPACES FOR YOUR OWN IDEAS.



Sliding door panorama wardrobe with synchronous opening and 2 drawers // version 4B // width 320 cm and height 240 cm // 4 doors // body: frosted terra // front: fango glass // central belt: imit. macadamia nutwood // handle fitments/lattice bars: chrome // bed frame: CONCEPT ME 500



Folding door planning wardrobe with 3 drawers // version 1 // width 330 cm and height 240 cm // 6 doors // body: imit. macadamia nutwood // front: fango glass // passe partout and shelf unit with set of 2 drawers in imit. macadamia nutwood // handle fitments: chrome // bed: CONCEPT ME 500 // bedside chest: CONCEPT ME 700





## HUSSHHHH, QUIET!



Scan and watch  
the film!

Some major innovations lie behind the generous doors of Marcato 2.0. State-of-the-art fittings technology guarantees that they slide like silk and close almost silently.

## MMMHHHH, SMART!



Sliding door wardrobe // version 3 //  
width 300 cm and height 223 cm // 3 doors //  
body: basalt // front: basalt glass //  
handle fitments and lattice bars: black

The technology is just the start of this love affair. The inner values are also stylish and harmonious: from the compartment layout to the high quality linen texture of the drawer interiors. Every detail is perfect.

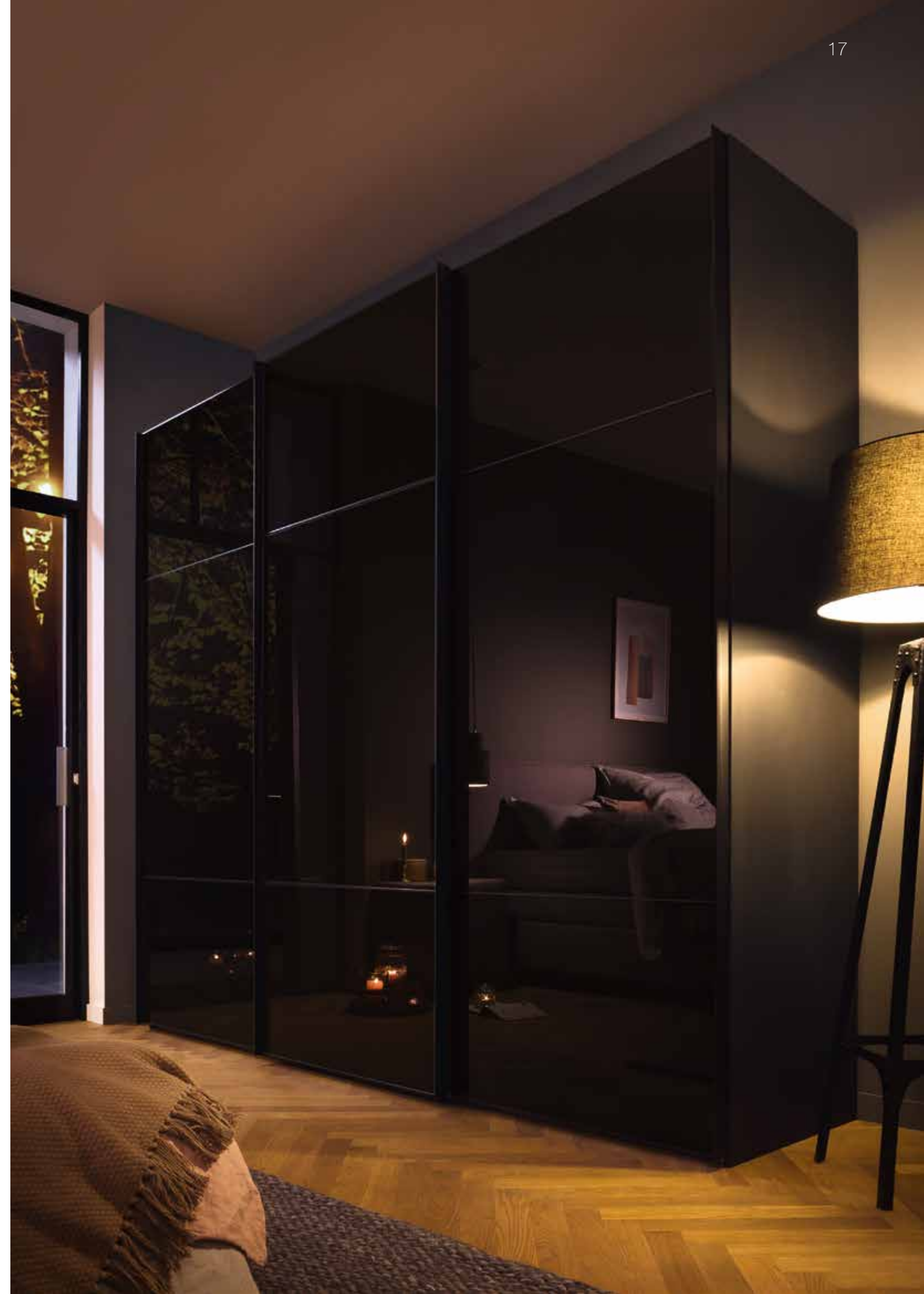

## BIG BLACK WARDROBE FOR THE LITTLE BLACK DRESS.



Hinged and sliding door wardrobe with drawers // version 1 // width 300 cm and height 240 cm // 6 doors // body: basalt // front: basalt glass // handle fitments: chrome



Combination of hinged and sliding doors // version 3 // width 300 cm and height 240 cm // 4 doors // body: basalt // front: basalt glass // handle fitments: chrome



### *Open hearted*

A full 2 metres of access to your clothing – that's freedom of choice!

### *Highlight*

A sophisticated lighting system with a single remote controller for up to four light sources. Exactly as you wish.



Also available as APP.



Beautiful detail: the vertical light band along the chrome handle edge. The connecting panel with LED light bands is dimmable and operated by remote control.



## TAKE A LOOK AROUND, IT'S BEAUTIFUL.



Sliding door wardrobe // version 1 // width 160 cm and height 223 cm // 2 doors // body: basalt // front: basalt/crystal mirror // handle fitments and lighting 107: frosted aluminium

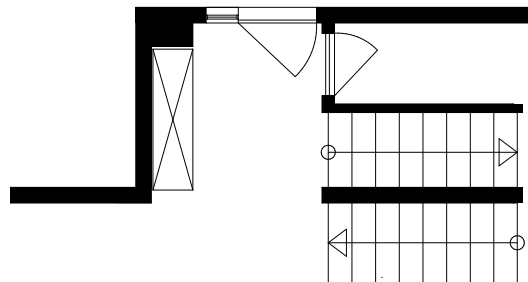

First impressions count – so make your hall count, too. The hall is the ugly duckling of many homes – either crammed with odds and ends or simply lacking inspiration. But wait, help is at hand! All you need to clear up your hall is an attractive wardrobe for your shoes, jackets, scarves, hats & co.

Spot the trick: this sliding door wardrobe is just 51 cm deep. Ideal for storing everything tidily in a narrow hall with limited space.

## LET THERE BE SPACE! WHERE THERE USED TO BE NONE.



Sliding door wardrobe // version 1 // width 160 cm and height 223 cm // 2 doors // body: polar white // front: white glass // handle fitments and lighting 107: chrome // chest: CONCEPT ME 700

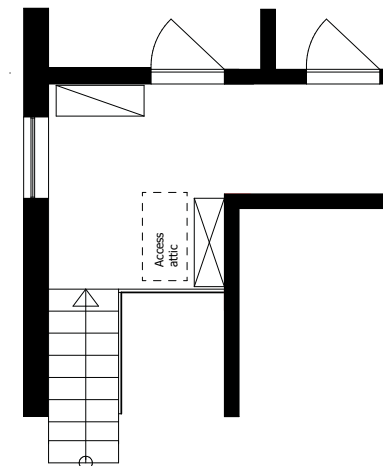

Children's rooms are small. Almost always too small. But intelligent storage space solutions make the most of even the smallest homes. Just like this! This sliding door wardrobe is just 42 cm deep allowing you not just to fold down the attic ladder – but also store linen, toys and other items in the hallway rather than the children's bedroom. Keeping things tidy. And giving you lots of space to make a mess again.

# PROFILE

- Sliding door, hinged door and folding door wardrobes
- Wardrobe configurations with a variety of door types (e.g. a combination of sliding and hinged doors)
- A wide selection of finishes, styles, heights, widths, and depths available for configuring your customised wardrobe
  - Dimensions
    - 3 heights (197/223/240 cm)
    - 9 widths for sliding door wardrobes from 160 up to 400 cm
    - hinged and folding doors – unlimited customisable
    - sliding door wardrobes in 2 depths (51/69 cm)
  - Corner solutions
  - Made-to-measure (reductions, slopes) e.g. for roof slopes
  - 8 body colours
  - 8 front colours and 10 glass fronts
  - Handle fitments and lattice bars in 4 colours
  - 2 interior finishes
  - 6 front versions (with and without lattice bars)
- Optimum use of storage space with a huge range of wardrobe accessories
- Sophisticated storage space functions
- ALEGRO chest system with matching style and colour scheme
  - 24 bedside chest versions in 6 heights (34/41/47/53/60/66 cm) and 4 widths (40/50/60 cm)
  - 74 chest versions in 3 heights (79/92/104 cm) and 8 widths (40/50/60/80/120/140/160/180 cm)
- Colour coordinated bed systems SONYO and SONYO+



Sliding door wardrobe with integrated coat rack at the side // width 300 cm and height 223 cm // version 3 // 3 doors // body: imit. Sonoma oak/ // front: white glass/ crystal mirror // handle fitments and lighting 55: chrome



SLIDING DOOR WARDROBES

**Dimensions**

3 heights (197, 223, 240 cm)

2 depth (51\*/69 cm)

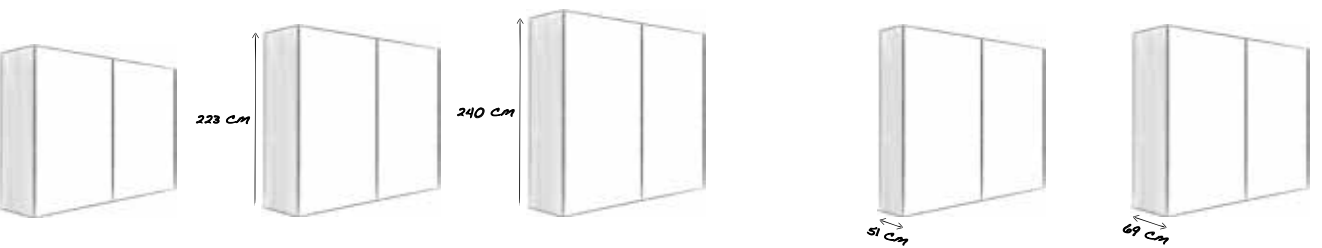

9 widths (2 doors: 160/180/200 cm, 3 doors: 240/270/300 cm, 4 doors\*\*: 320/360/400 cm)

\* Depth 51 cm available up to 300 cm width

\*\* Also available as panorama wardrobe

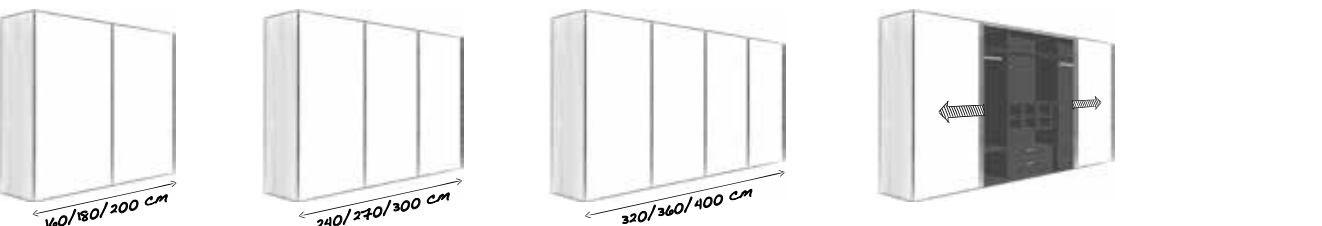

Front versions

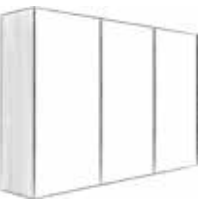

Version 1  
Front without lattice bars



Version 2  
Front with 3 horizontal lattice bars



Version 3  
Front with 4 horizontal lattice bars



Version 4A  
Front with 4 horizontal lattice bars

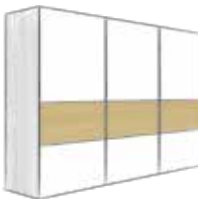

Version 4B  
Front with 4 horizontal bars and central belt in contrasting colours



Version 5  
Front with 5 horizontal lattice bars

Mirrored fronts



Mirrored doors in versions 1, 2, 3, 5

Customisation

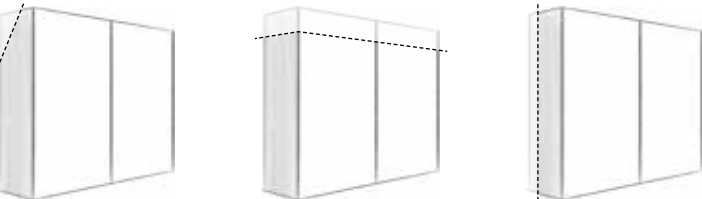

Back slope

Reduced height

Reduced depth

FUNCTIONAL SLIDING DOOR WARDROBES

**20 cm exterior shelf and 20 cm mirror panel (can be installed on the left or right)**

2 heights 223/240 cm // 4 widths: 160/200/240/300 cm // depth: 69 cm

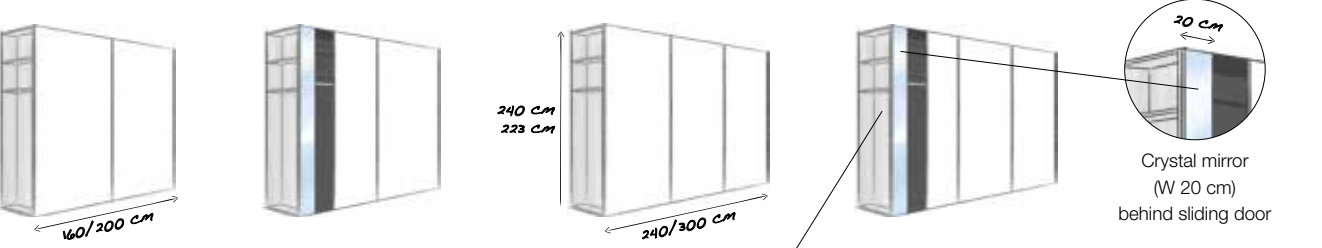

Available in versions 1 to 5

Accessories: additional shelves, metal rod, storage trays, hanger holders, LED light band

Crystal mirror (W 20 cm) behind sliding door

**Integrated coat rack and 40 cm linen compartment (can be installed on the left or right)**

2 heights: 223/240 cm // 6 widths: 160/180/200/240/270/300 cm // depth: 69 cm

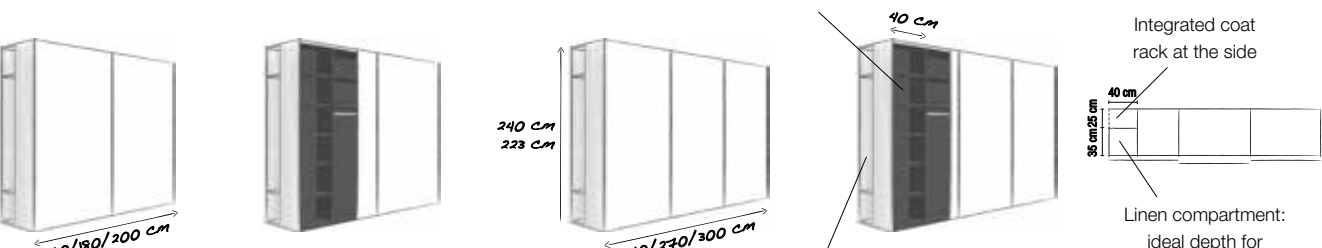

Available in versions 1 to 5

40 cm linen shelf with 5 shelves  
W 40 cm, D 35 cm

Integrated coat rack at the side

Coat rack

Linen compartment: ideal depth for T-shirts, pullovers, bed linen

Sliding door panorama wardrobe with synchronous opening and 2 drawers

2 heights: 223/240 cm // 3 widths: 320/360/400 cm // depth: 69 cm

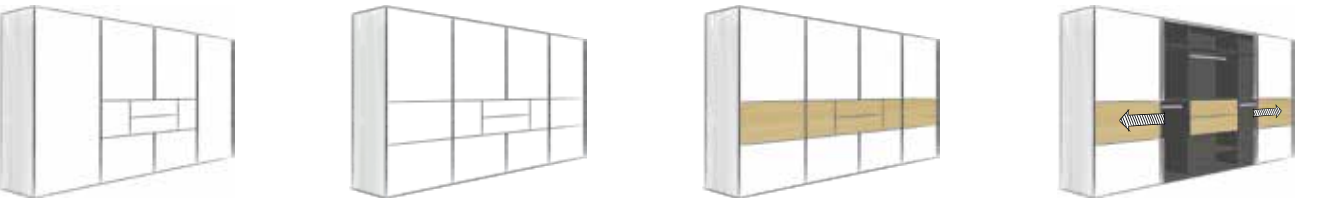

Version 1  
Front without lattice bars

Version 4A  
Front with 4 horizontal lattice bars

Version 4B  
Front with 4 horizontal bars and central belt in contrasting colours

Version 4B  
Front with 4 horizontal bars and central belt in contrasting colours

Available in versions 1, 4A and 4B

Pelmet and passe partout:



Version 1  
Pelmet

Version 2  
Pelmet with LED lighting

Version 3  
Passe partout

Version 4  
Passe partout with LED lighting

HINGED AND FOLDING DOOR WARDROBES

Planning logic

Starter unit + Add-on units

Unlimited customizable

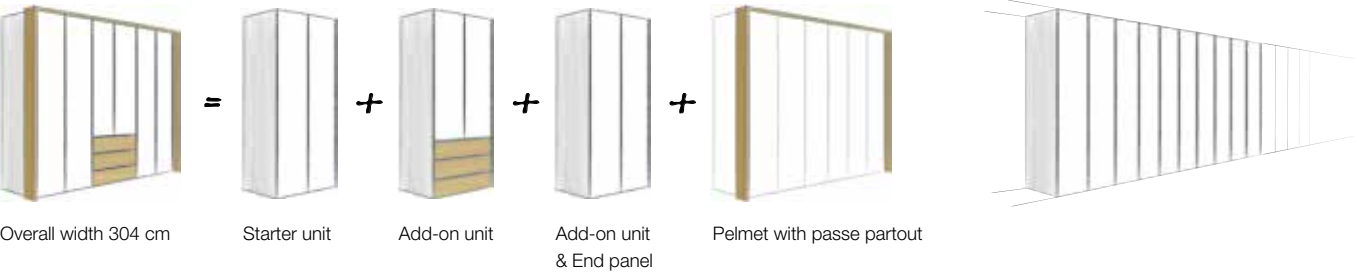

Dimensions

3 heights (197, 223, 240 cm)

Depth (62 cm)

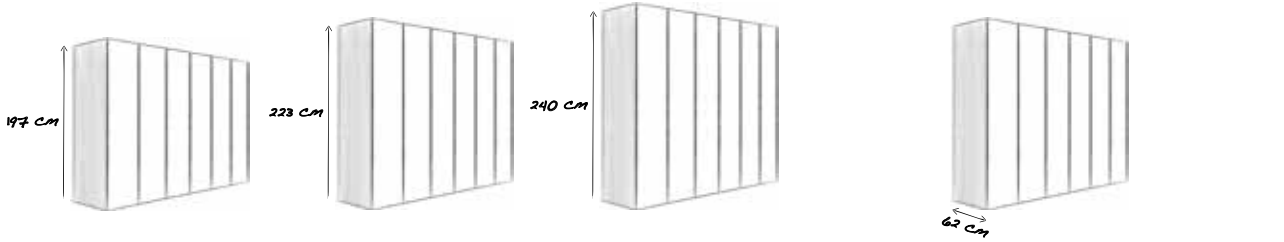

Hinged door widths (1 door: 50 cm, 2 doors: 100 cm)

Folding door widths (2 doors: 100 cm, 4 doors: 200 cm)

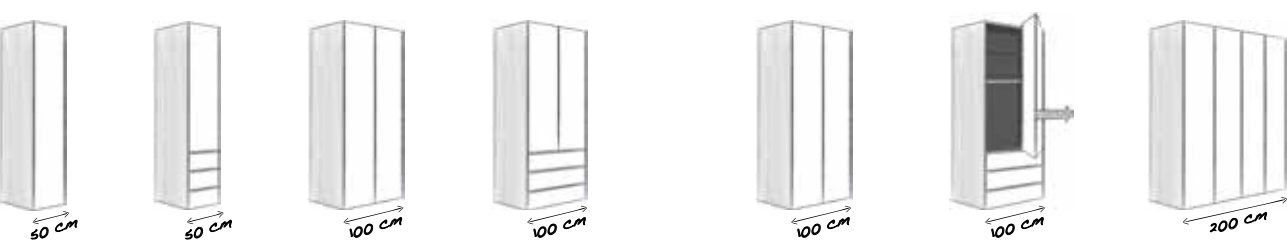

Special units

Extention coat rack

Shelf unit

Set of 2 drawers for shelf unit

Corner units

45° corner unit 1 door

45° corner unit 1 door

90° corner unit 2 doors

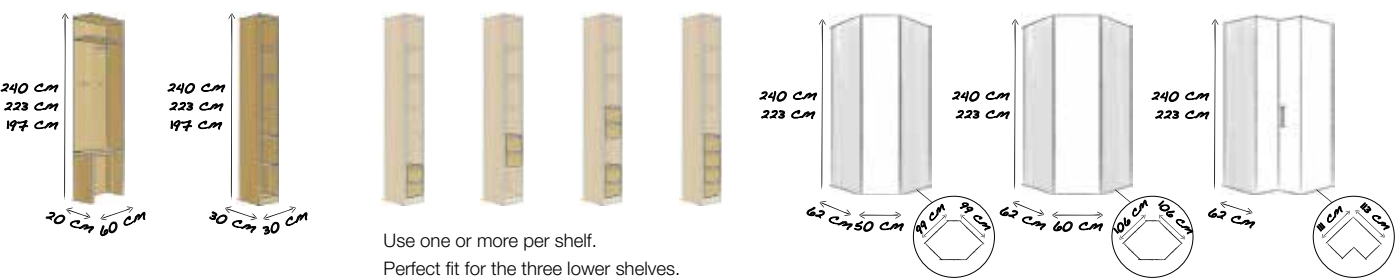

Customisation

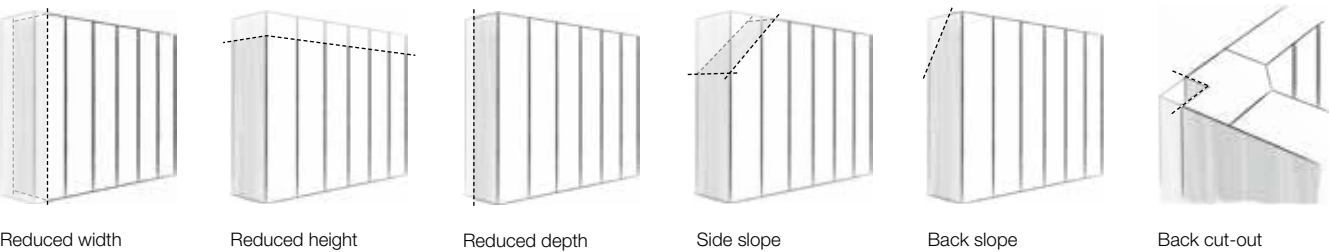

HINGED AND FOLDING DOOR WARDROBES

Front versions



Examples

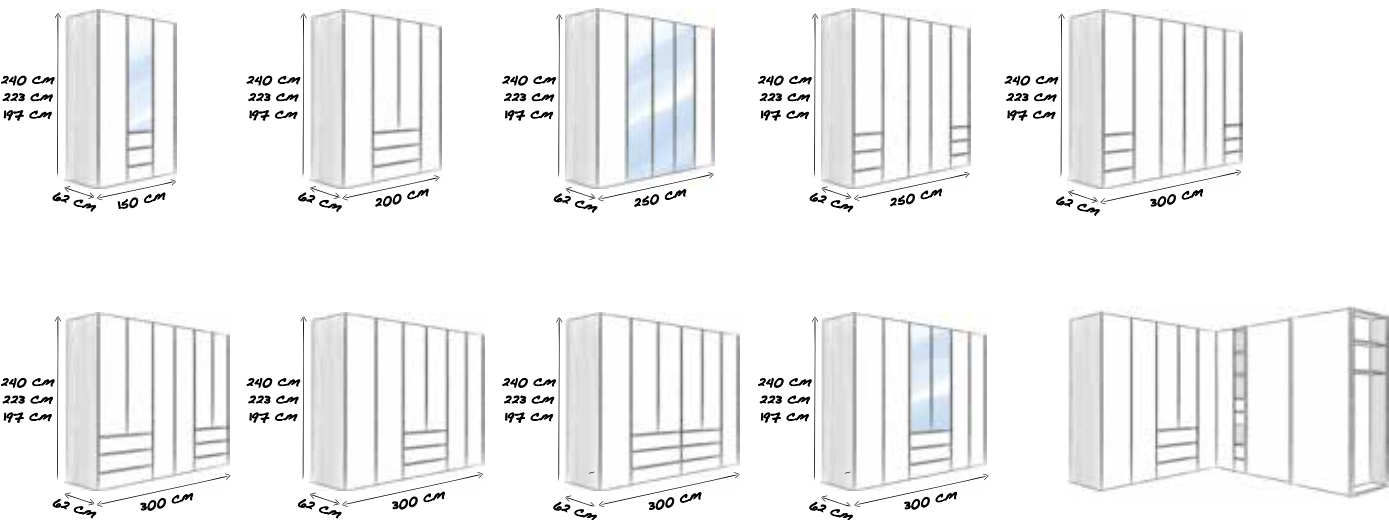

Pelmet and passe partout





THE SURFACES

8 body colours // 8 front colours

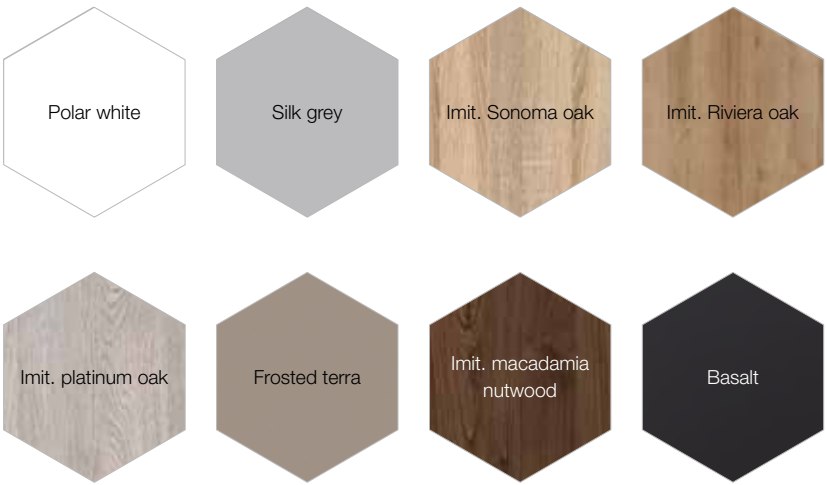

2 interior finishes



10 glass fronts

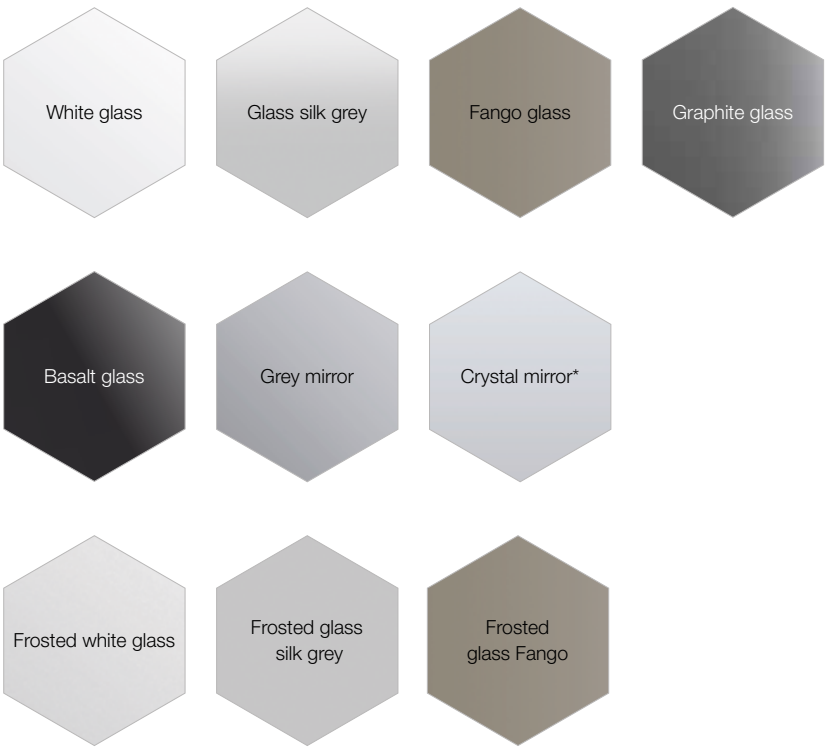

Handle fitments & lattice bars

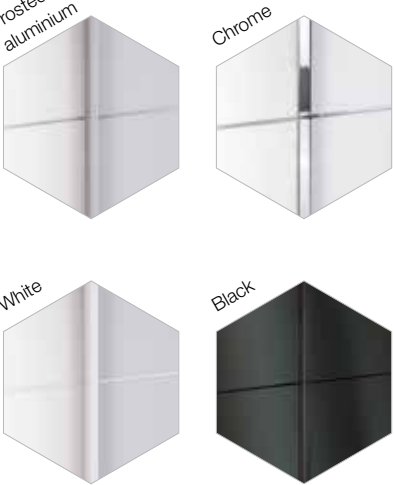

\* Not available as drawers.

Room with a view: Marcato 2.0 makes glass the star. Glass has been used in interior design for centuries. And its purity, strength and quality still have the power to fascinate. Glass retains its colour, is scratch resistant, easy to clean and blends into its surroundings perfectly. Its smooth, polished surface creates a magical interplay of light, shadow and sparkling reflections. A real eye-catcher!



AS UNIQUE AS YOUR IMAGINATION:  
OUR WARDROBE ACCESSORIES.



Interior finish imitation birch // from left: swing-down rail, trouser holder 2A, set of 2 GLASSLINE interior drawers // LED interior lighting, shelves, shelving fitment // shelf, sliding interior crystal mirror, hanging rail, storage tray 1A, shelf, set of 2 GLASSLINE interior drawers



Interior finish Twist linen look // from left: swing-down rail // pull-out shelf with railing // 4 WOODLINE interior drawers // LED interior lighting // shelves // shelving fitment // swing-down rail, trouser holder 2A, storage tray 1A // external rail 2

**YOU WILL FIND  
OUR ACCESSORIES  
UNDER:**

[www.nolte-moebel.de/en/accessories.html](http://www.nolte-moebel.de/en/accessories.html)



Scan and discover  
your wardrobe accessories.



From drawers, rails and baskets to swing-down rails, mirrors and many other accessories – our digital assistant transforms MARCATO 2.0 into your personal wardrobe.



Interior finish Twist linen look // from left: shelves, hanging rail, shelving fitment WOODLINE: 3 drawers with wooden front, open compartments // shelves, shelving fitment // swing-down rail, set of 2 WOODLINE interior drawers, shelves // external rail 2



# GENEROUS IN EVERY WAY: FURNITURE WITH BENEFITS.

1 INNOVATIVE FITTINGS TECHNOLOGY



- Opens smoothly at the lightest touch
- Floating sensation – doors run quietly and smoothly
- Quick installation of the lower guide rail using clips with automatic height adjustment – no tools required
- Rails and damping system in attractive yet discrete design

4 REDUCED BASE HEIGHT



Reduced base height of 40 mm: greater stability and more storage space.

7 FULL ACCESS



Doors open even wider (+ 46 mm): better access to the wardrobe interior and more efficient use of accessories. Door offset of only 34 mm.

10 METAL RAILS

Upper and lower rails made of metal.

13 COMFORT

The elegantly rounded metal handle fittings sit perfectly in the hand. Innovative fittings ensure the large sliding doors open and close easily at the lightest touch.

2 SOFT CLOSE

Soft Close ensures doors close gently (optional), adjustable closing and damping settings. Advantage: these settings can be adjusted to the materials chosen for the front. Whether you order glass or another finish – simply adjust the damping effect to the appropriate level.

5 HARMONIOUS LOOK



No connecting bolts visible on the exterior.

8 HEIGHT COMPENSATION

Doors incl. automatic height adjustment of up to 5 mm. Ideal for use on uneven or convex floors.

11 DUST-BRUSHES

The dust brushes are elegantly integrated and thus virtually invisible.

14 HIGH STABILITY

Despite constant opening and closing, the sliding doors will stay easy to open for years to come. Metal wall mounts, clothing rail mounts, shelf supports and door fittings ensure long-term stability and toughness.

Threaded shelf supports with integrated pins (5 mm) connect the 22 mm thick shelves with the side panels and prevent them from sliding out.

3 DAMPING FOR OPENING AND COLLISIONS

Optional opening and collision damping for 2-door wardrobes: pulls the doors into the open position and dampens the interaction of the doors. Optional opening, collision and centre door damping for 3-door wardrobes: pulls the doors into the open position, dampens the interaction of the doors and aligns the centre door when closed.

6 REAR WALL



Optional 5 mm rear wall: for greater stability and no joint fold

9 INTEGRATED DUST GUARD

Angle at the top of the front door seals the body and prevents dust entering.

12 DURABILITY

Your wardrobe can be assembled and dismantled any number of times thanks to the fittings used for assembling its side panels. So you can enjoy it for years to come – even when you move to a new home.

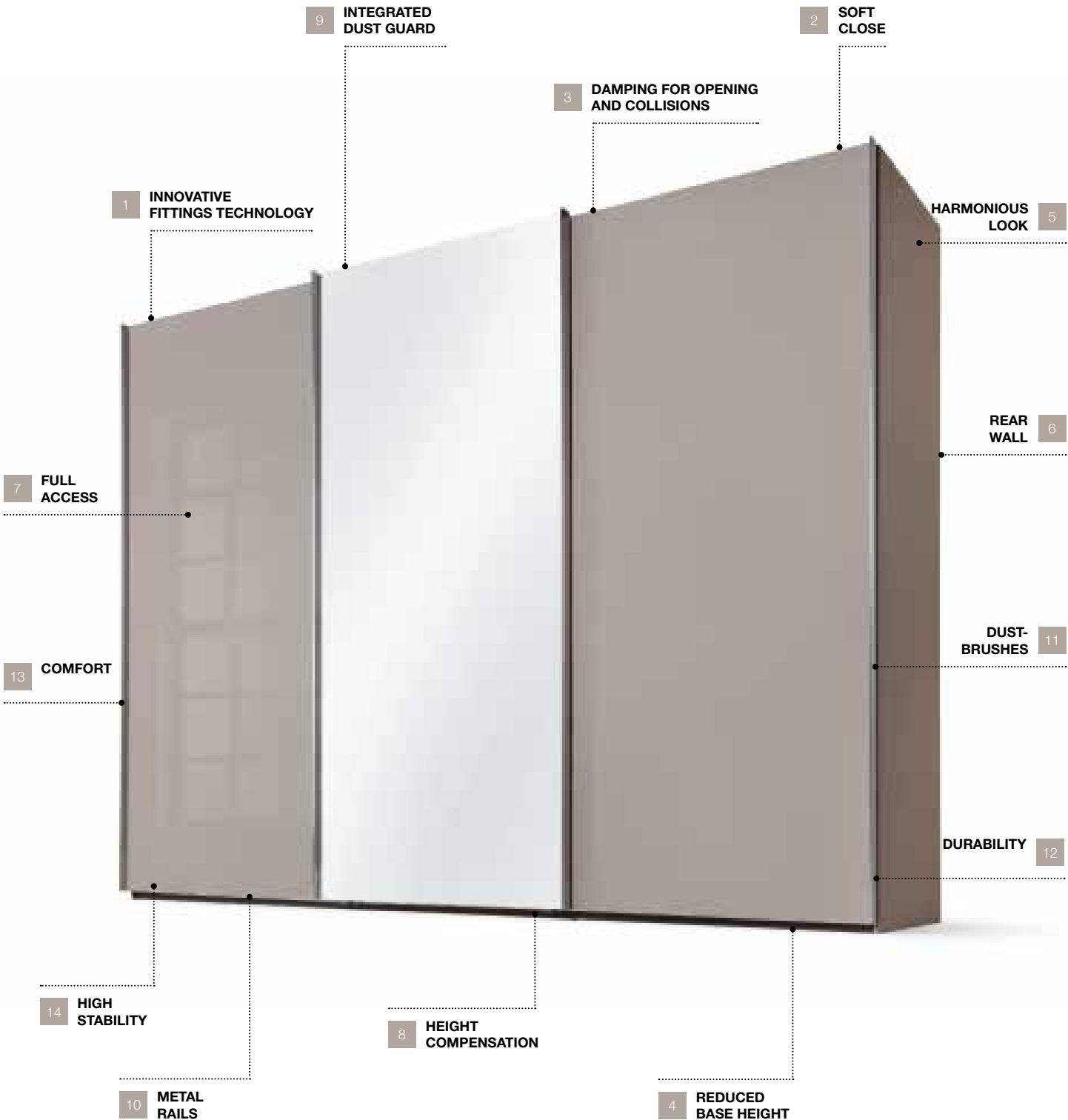

# PERFECT NOW. AND FOR YEARS TO COME.

## HUNDRED PER CENT 100% MADE IN GERMANY.

You can depend on every aspect of Nolte furniture – from safety to reliability and quality. For us, it's not just a question of aspirations but also of time – literally. Our company is in its fourth generation of family management so we know what we're talking about – but more importantly how to make it work.

## MAXIMUM APPEAL AND THE HIGHEST QUALITY.

We were among the first to recognise that furniture with an exclusive design and uncompromising quality has to be made in Germany. Moreover, we use state-of-the-art technologies and environmentally-friendly manufacturing processes. In other words: at Nolte, we don't just talk about sustainability – we live it.



MADE IN GERMANY



## 10 YEAR GUARANTEE

Life is full of surprises. We have voluntarily extended our guarantee to 10 years so you can relax and enjoy your new furniture with real peace of mind. The guarantee offers you an unique level of security.



[www.blauer-engel.de/uz38](http://www.blauer-engel.de/uz38)

## THE BLUE ANGEL

Nolte furniture bears the "Blue Angel" (Der blaue Engel) seal for products made from wood and wood materials with exceptionally low emissions. It certifies that we implement strong measures to protect your health and the environment and use resources efficiently.



## THE GOLDEN M

The "Golden M" is the quality mark for products offering outstanding performance. So you can be certain that your quality furniture will accompany you for many years.



## QUALITY ALLIANCE

The seal of the "Quality Alliance" (Bündnis für Qualität) is a guarantee of high product quality, simplified logistics and high standards of assembly.



Das Zeichen für verantwortungsvolle  
Waldwirtschaft

## FSC

The FSC® "Forest Stewardship Council®" is an independent NGO founded in 1993. It campaigns for forestry management techniques which meet sustainable environmental, social and economic standards around the world.



Förderung nachhaltiger  
Waldwirtschaft

[www.pefc.de](http://www.pefc.de)

## PEFC

PEFC™ stands for the "Programme for the Endorsement of Forest Certification Schemes". The PEFC was founded in 1999 and is a transparent, independent system for ensuring sustainable forestry management.







06/18-VM316NOGB All specified sizes in cm are approximative! We reserve the right to make technical changes and poss. printing mistakes. Colours may vary from how they appear in print!

Nolte Möbel GmbH & Co. KG  
 Konrad-Nolte-Straße 20  
 D-76726 Gernersheim  
 Fon +49 (0) 7274 51-12 0  
 Fax +49 (0) 7274 51-12 210  
 info@nolte-moebel.de  
 www.nolte-moebel.de

**nolte**<sup>®</sup>  
 MÖBEL